

KEY PLAN

MRP | REALTY

680 Rhode Island Ave. | Washington, DC

April 29, 2016 | 1.203

SK+I  
ARCHITECTURE

Perspective

ZONING COMMISSION  
District of Columbia  
CASE NO.15-16  
EXHIBIT NO.31E15



MRP | REALTY

680 Rhode Island Ave. | Washington, DC

April 29, 2016 | 1.204

SK+I  
ARCHITECTURE

Perspective

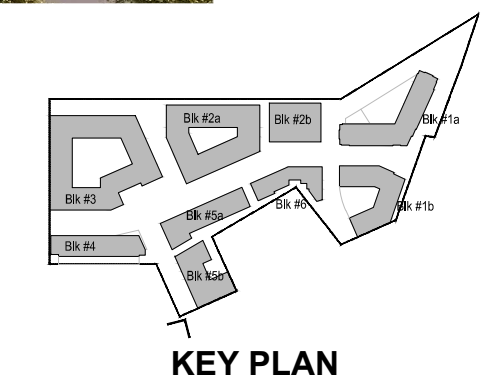

MRP | REALTY

680 Rhode Island Ave. | Washington, DC

April 29, 2016 | 1.205

SK+I  
ARCHITECTURE

Perspective

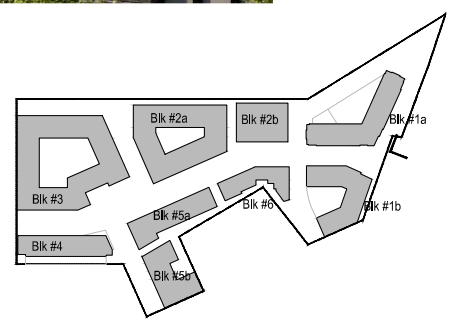

**KEY PLAN**

**MRP** | REALTY

680 Rhode Island Ave. | Washington, DC

April 29, 2016 | 1.206

**SK+I**  
ARCHITECTURE

Perspective

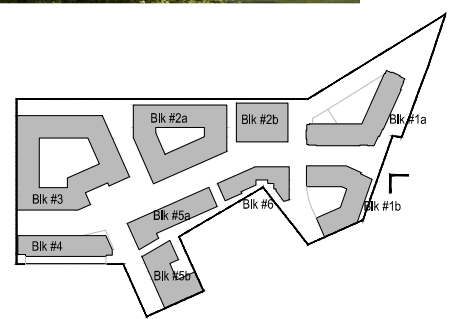

KEY PLAN

MRP | REALTY

680 Rhode Island Ave. | Washington, DC

April 29, 2016 | 1.207

SK+I  
ARCHITECTURE

Perspective



●	PH max. EL +215.60'
●	Roof EL +203.60'
●	07 Level EL +189.60'
●	06 Level EL +178.94'
●	05 Level EL +168.28'
●	04 Level EL +157.63'
●	03 Level EL +146.97'
●	02 Level EL +136.31'
●	01 Level EL +114.00'
●	Measuring Point EL +113.60'

**MATERIALS**

- 1. Brick 1
  - 2. Brick 2
  - 3. Brick 3
  - 4. Metal Balcony
  - 5. Metal Channel
  - 6. Metal Panel 1
  - 7. Metal Panel 2
  - 8. Metal Railing
  - 9. Metal Window 1
  - 10. Metal Window 2
  - 11. Precast Stone 1
  - 12. Precast Stone 2
  - 13. Precast Stone 3
  - 14. Stone
- See Sheets 1.501 to 1.506  
for material locations

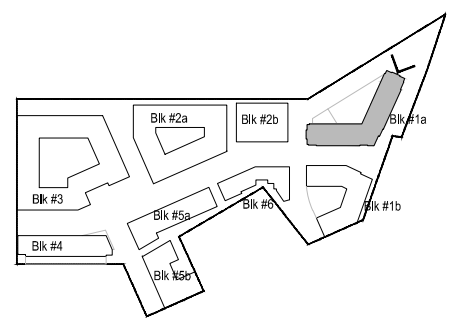

**KEY PLAN**

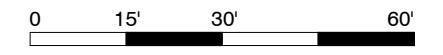



**MATERIALS**

1. Brick 1
  2. Brick 2
  3. Brick 3
  4. Metal Balcony
  5. Metal Channel
  6. Metal Panel 1
  7. Metal Panel 2
  8. Metal Railing
  9. Metal Window 1
  10. Metal Window 2
  11. Precast Stone 1
  12. Precast Stone 2
  13. Precast Stone 3
  14. Stone
- See Sheets 1.501 to 1.506 for material locations

- PH max.  
EL +215.60'
- Roof  
EL +203.60'
- 07 Level  
EL +189.60'
- 06 Level  
EL +178.94'
- 05 Level  
EL +168.28'
- 04 Level  
EL +157.63'
- 03 Level  
EL +146.97'
- 02 Level  
EL +136.31'
- 01 Level  
EL +114.00'
- Measuring Point  
EL +113.60'



Retail Option

Signage Canopy Area

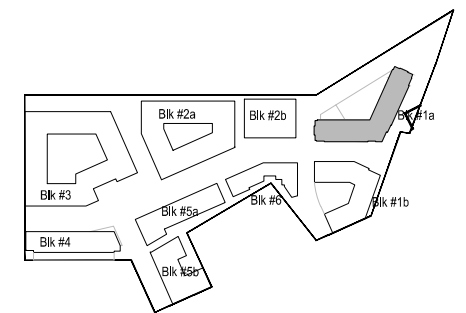

**KEY PLAN**